

EC type-examination certificate



Certificate no.: ABFV 522/1

Notified body: TÜV Süddeutschland Bau und Betrieb GmbH
Zertifizierungsstelle
für Aufzüge und Sicherheitsbauteile
Westendstraße 199, D-80686 München

**Applicant/
Certificate holder:** Montanari Giulio & C. s.r.l.
Via Bulgaria, 39
I-41100 Modena

Date of submission: 2000-04-20

Manufacturer: Montanari Giulio & C. s.r.l.
Via Bulgaria, 39
I-41100 Modena

Product, type: Progressive safety gear with braking device as part of
the protection device against overspeed for the car
moving in upwards direction, type PP-35 CE

Test Laboratory: TÜV Süddeutschland Bau und Betrieb GmbH
Abteilung Aufzüge und Sicherheitsbauteile
Westendstraße 199, D-80686 München

**Date and
Number of test report:** 2000-07-14
522/1

EC-directive: 95 / 16 / EC

Statement: The safety component conforms to the directive's
safety requirements for the respective scope of appli-
cation stated on page 1 and 2 of the annex to this EC
type-examination certificate.

Certificate date: 2000-07-14

Zertifizierungsstelle für Aufzüge und Sicherheitsbauteile
EC-Identification number: 0635

Peter Tkalec

CERTIFICAT

CERTIFICADO

‘EPITITATH

認証証書

CERTIFICATE

ZERTIFIKAT

Annex to the EC type-examination certificate No. ABFV 522/1

1. Scope of Application

- 1.1 Progressive safety gear (acting downwards)
Permissible total mass of car and rated load or counterweight in using one pair of safety gears, depends on manufacture and condition of the guide rail running surface

Manufactured by and condition	Total mass (kg)	
	min.	max.
drawn/dry	706	3551
drawn/oiled*	766	3290
machined/dry	780	3797
machine/oiled*	702	4109

*Mineral oils without additives (e.g. lubricating oils C according to DIN 51517 part 1)

- 1.2 Brake device (acting upwards)
Permissible brake force when using the braking devices in twos, depends on manufacture and condition of the guide rail running surface

Manufactured by and condition	Brake force (N)	
	min.	max.
drawn/dry	11088	55735
drawn/oiled*	12028	51635
machined/dry	12238	59592
machine/oiled*	11023	64495

*Mineral oils without additives (e.g. lubricating oils C according to DIN 51517 part 1)

- 1.3 Maximum tripping speed of overspeed governor and range of the maximum rated speed

Maximum tripping speed (m/s)	3,22
Maximum rated speed (m/s)	2,50 - 2,80

- 1.4 Guide rails to be used

- 1.4.1 Minimum running surface width 32 mm
- 1.4.2 Blade width 6 - 16 mm

2. Conditions for the brake device

- 2.1 Since the brake device represents only the decelerating element of the protection device against overspeed for the car moving upwards direction against overspeed, the speed monitoring element for upwards direction must be an overspeed governor which also retracts the brake device as per EN 81-1, section 9.9.
- 2.2 The forces acting in upwards direction on the guide rails must be safely absorbed (e.g. without shifting the guide rails in upwards direction).

3. Remarks

- 3.1 Due to the characteristics, the braking force for the safety gear acting downwards and the braking force for the brake device acting upwards are not permanently related to each other. They can not be adjusted separately in principle. The permissible total mass stated in 1.1 thus also is permanently related to the permissible braking force as defined in 1.2.
- 3.2 The permissible brake forces must be applied to the lift system in such a manner, that the empty lift cabin travelling in an upwards direction is not decelerated by more than $1 g_n$.
- 3.3 Pursuant to the standard EN 81, annex F, paragraph 3, section 3.4 a) 2) the total mass determined for adjustment purposes may be 7,5% higher or lower.
- 3.4 In order to provide identification and information about the basic design and its functioning and to show the environmental conditions and connection requirements pertaining to the tested and approved type, and to define which parts have been tested, drawing number S 49012887 dated 5 July 2000 is to be enclosed with the EC type-examination certificate and the annex thereto.
- 3.5 The EC type-examination certificate may only be used in connection with the pertinent annex.

VARIANTE 2

VARIANTE 1

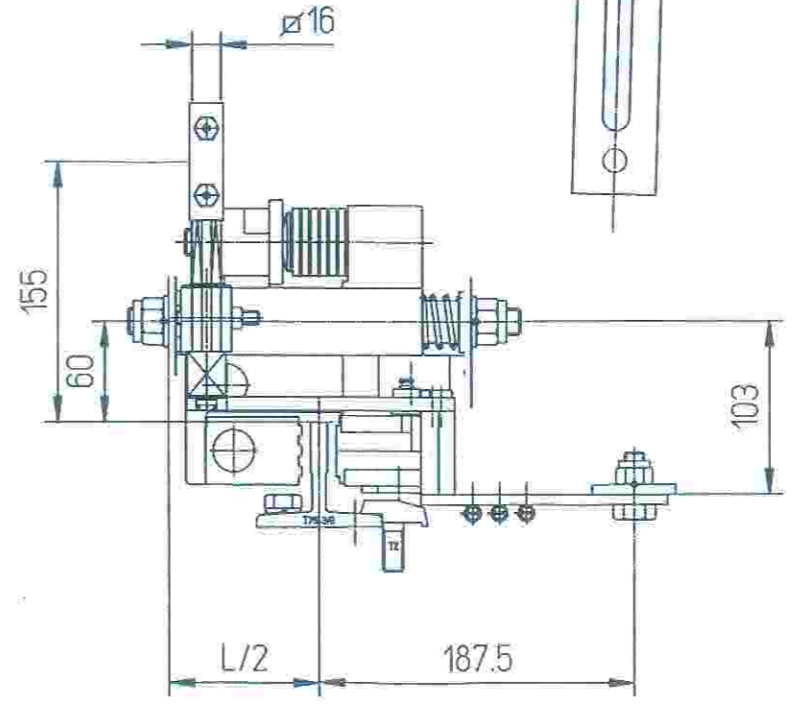
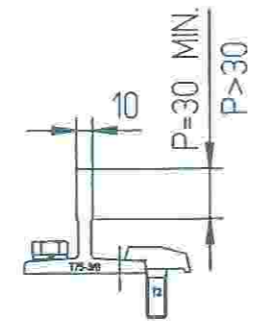
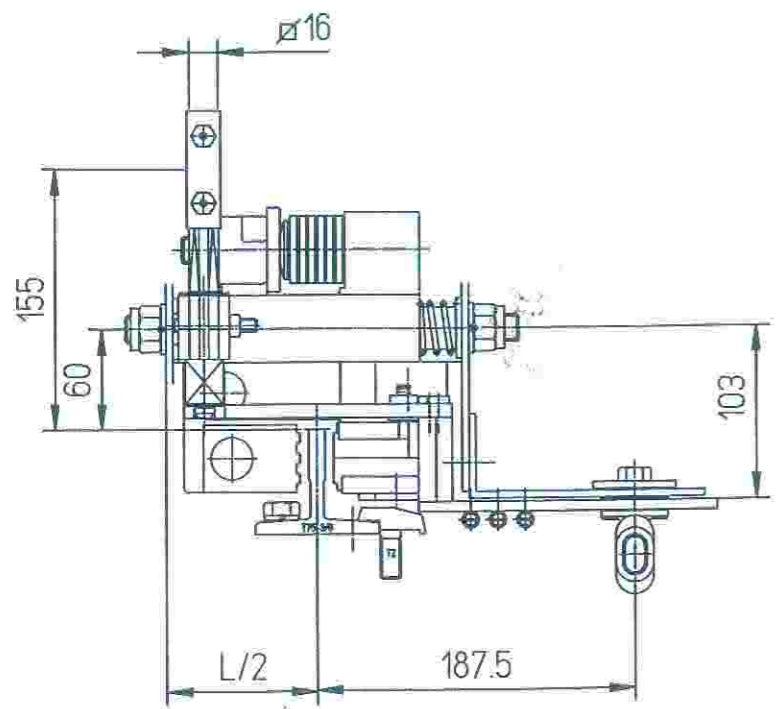
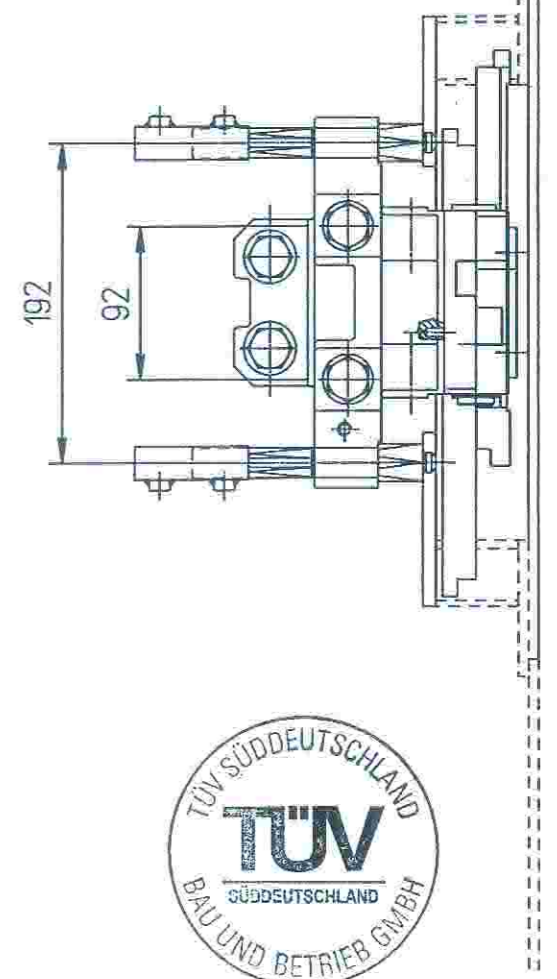
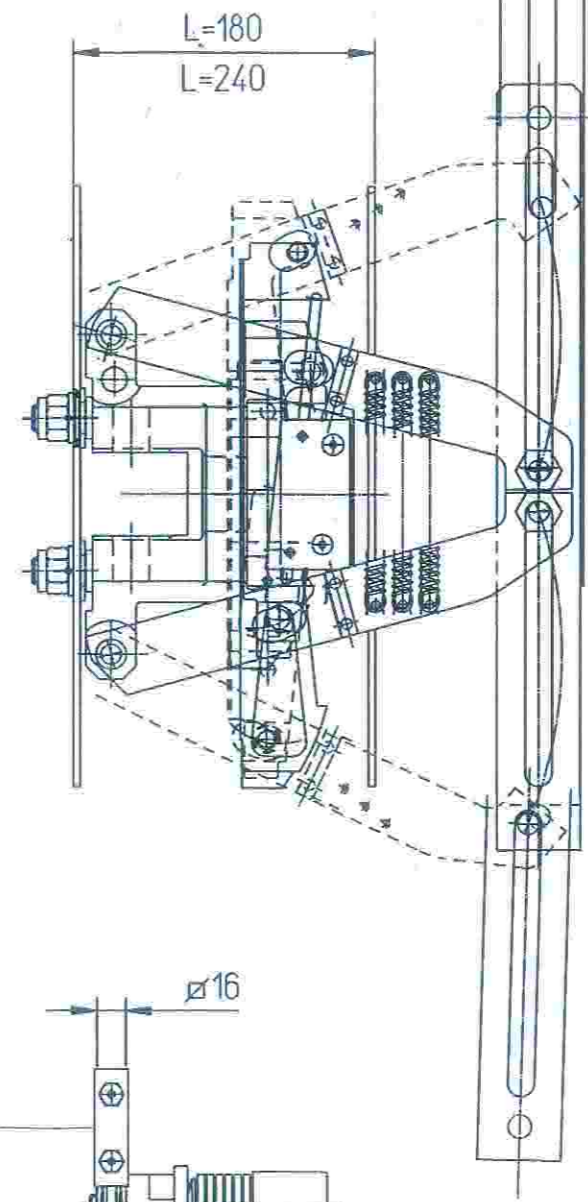
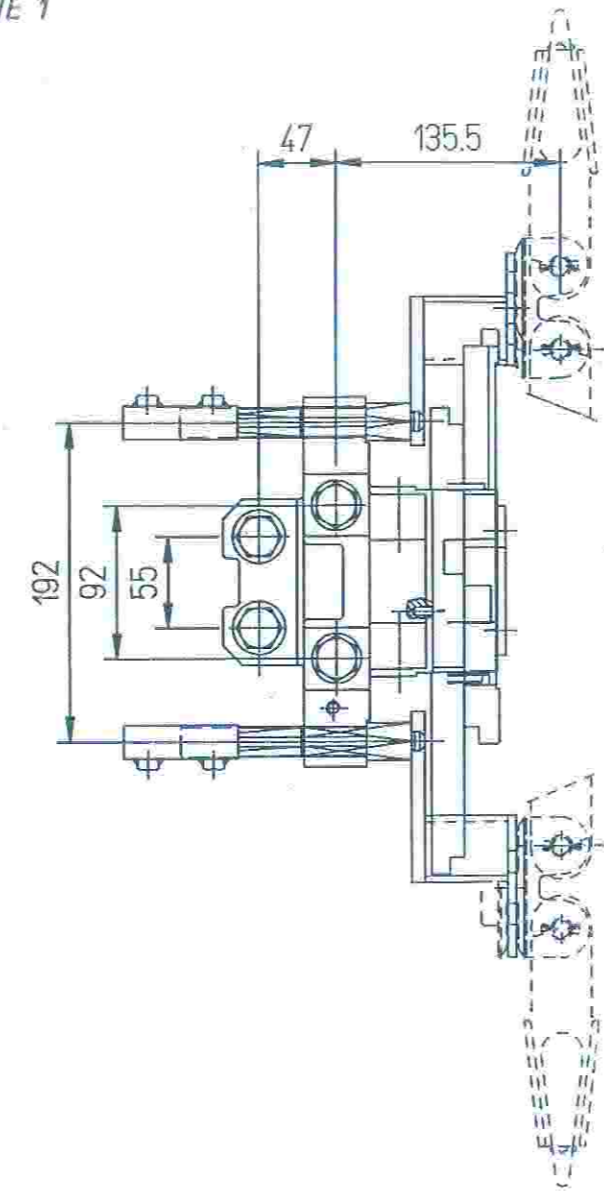
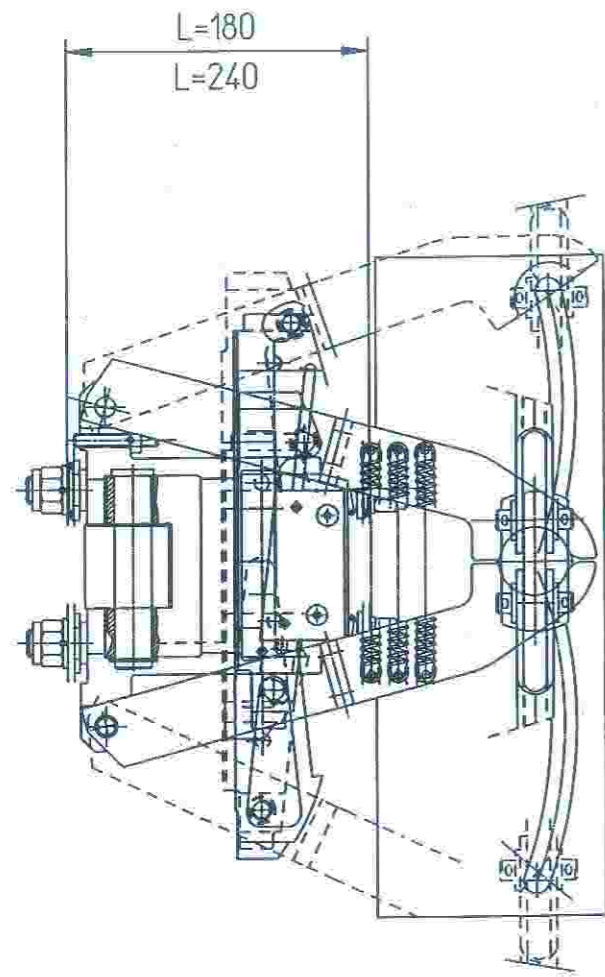

14. JULI 2000
 - GEPRÜFT -
 TÜV Süddeutschland Bau und Betrieb GmbH
 Abteilung Aufzüge und Sicherheitsbauteile
 Westendstr. 199, D-80686 München
 Der Sachverständige

[Handwritten signature]

TÜV SÜDDEUTSCHLAND		Sachverständigenamt	
PROJEKT	PP35CE	OBJEKT	Montanari Cludio
DATE	15/07/00	PLATZ	MÜNCHEN - BAYL
ZEICHNER	h. w. e.	PROJEKTANT	h. w. e.
PRÜFER	h. w. e.	PLATZ	704902087
BLOCCO PARACADUTE PP35CE		S4902087	